

FOR LEASE | RETAIL
1608 152 STREET
SURREY, BC



- **4,195 SF Prime South Surrey Retail Opportunity**
- **Exposure Location with Parking**

Location

This prime retail premises is located on the North East side of 152 Street at the corner of 16th Avenue, across from Semiahmoo Shopping Centre in White Rock

Highlights

- Excellent street front prominence
- Signage opportunity
- Floor to ceiling double glazed windows
- Front and rear parking
- Close to transit

Ryan Saunders

Personal Real Estate Corporation

D 604.630.3384 C 604.760.8799

ryan.saunders@lee-associates.com

FOR LEASE | RETAIL 1608 152 STREET SURREY, BC

Zoning

C-8 (Community Commercial) – allowable uses include various retail stores, personal service uses, offices, eating establishments, liquor stores, entertainment uses, community service.

Improvements

This unit has been fully renovated with HVAC, T-Bar ceiling, fluorescent lighting, and washroom facilities. Front and rear parking is provided for customers.

Features

- ▶ Exposure location
- ▶ High profile corner
- ▶ Fully HVAC
- ▶ 10 -12' ceilings
- ▶ Signage opportunity
- ▶ Wide array of tenants
- ▶ Kitchen area



Available Premises

4,195 SF

Availability

June 1, 2020

Rental Rate

\$45.00 PSF triple net per annum

Operating Costs & Taxes (2020)

Estimated \$13.25 PSF per annum plus management fees

Comments

The premises enjoy access and exposure from 152nd Street and 16th Avenue across from the Semiahmoo Shopping Centre.

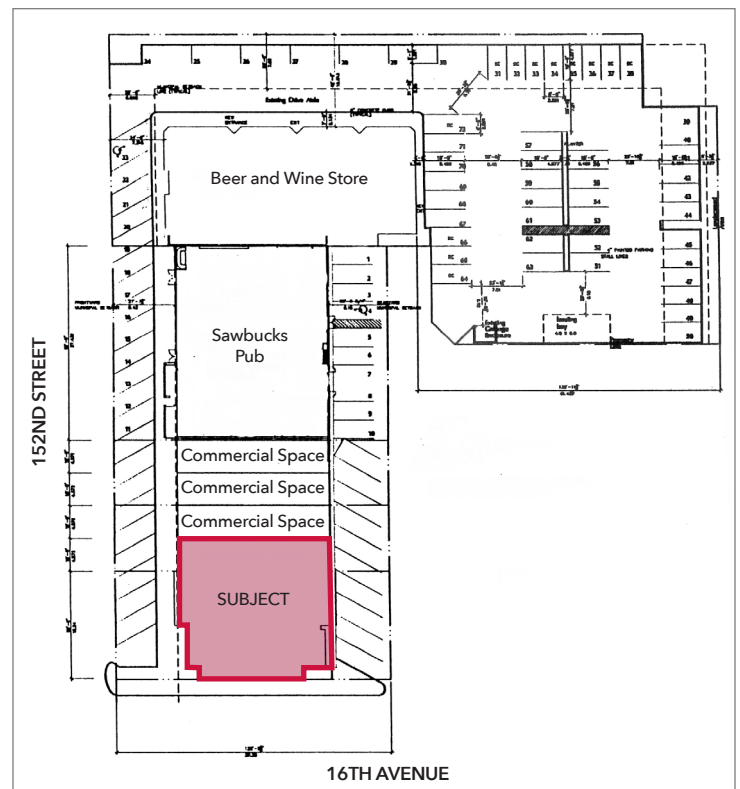

Ryan Saunders

Personal Real Estate Corporation

D 604.630.3384 C 604.760.8799

ryan.saunders@lee-associates.com

Disclaimer: Although the information contained within is from sources believed to be reliable, no warranty or representation is made as to its accuracy being subject to errors, omissions, conditions, prior lease, withdrawal or other changes without notice and same should not be relied upon without independent verification. 0121 © 2020 Lee & Associates Commercial Real Estate (BC) Ltd. All Rights Reserved.