



516 | JOHN STREET N
AYLMER, ON

Partnership. Performance.

Industrial Space for Lease

- 50 acre lot
- Up to 2,000 amps of power
- \$1.50 psf additional rent across buildings
- 2,679 feet of frontage facing John Street
- Flexible zoning - Heavy Industrial, Light Industrial, Commercial (M2-2)

Charlie Gobert

Principal, Sales Representative
226.289.2836
charlie.gobert@avisonyoung.com

Building 6D & 7D



18,815 sf

Building 7D



18,815 sf

Building 6D



John Street N

Street Facing



18 feet

Clear Height



6 TL / 1 DI

Shipping



\$3.50 psf - \$4.50 psf

Asking Net Rate



\$1.50 psf

Additional Rent

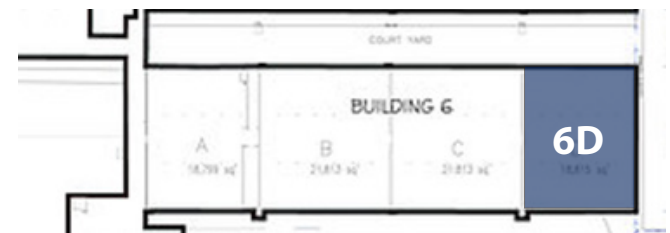

avisonyoung.ca

Avison Young Commercial Real Estate
Services, LP, Brokerage
355 Wellington Street, Suite 237
London ON N6A 3N7
T 226.366.9090 F 866.541.9755

Charlie Gobert
Principal, Sales Representative
226.289.2836
charlie.gobert@avisonyoung.com