



FOR LEASE

GRANVILLE ENTERTAINMENT DISTRICT
906 GRANVILLE STREET
VANCOUVER, BC

"MOVIELAND ARCADE" BUILDING // 3,882 SF



Flavio Unti
Sales Associate
Industrial Sales & Leasing
604 640 5889
flavio.unti@cushwake.com

Adam Frizzell
Vice President
604 640 5840
adam.frizzell@cushwake.com



FOR LEASE

GRANVILLE ENTERTAINMENT DISTRICT
906 GRANVILLE STREET
VANCOUVER, BC

ABOUT THE AREA

The 900 block of Granville Street is characterized by pubs and clubs, restaurants and music venues which place the subject property in the heart of the Granville Entertainment District. The property is located close to multiple transit routes including Granville Station Skytrain and the Canada Line at Yaletown-Roundhouse. Located on the corner of Granville and Smithe this property is strategically located in the downtown core with an abundance of shopping and restaurants in the immediate vicinity allowing for high traffic and pedestrian exposure with great visibility.

AVAILABLE AREA

Main Floor	2,985 sf
Basement	897 sf
Total Area	3,882 sf

DEMOGRAPHICS

Within 1 km of The Property

Businesses	5,705
Daytime Working Population	107,512
Total Population	55,985
Households	24,287
Average Household Income	\$76,342
Median Age	36.2
University Degree	50.1%

ASKING NET LEASE RATE

\$45.00 psf, annum

PROPERTY TAXES & OPERATING COSTS

\$15.00 psf, annum (budget 2019)

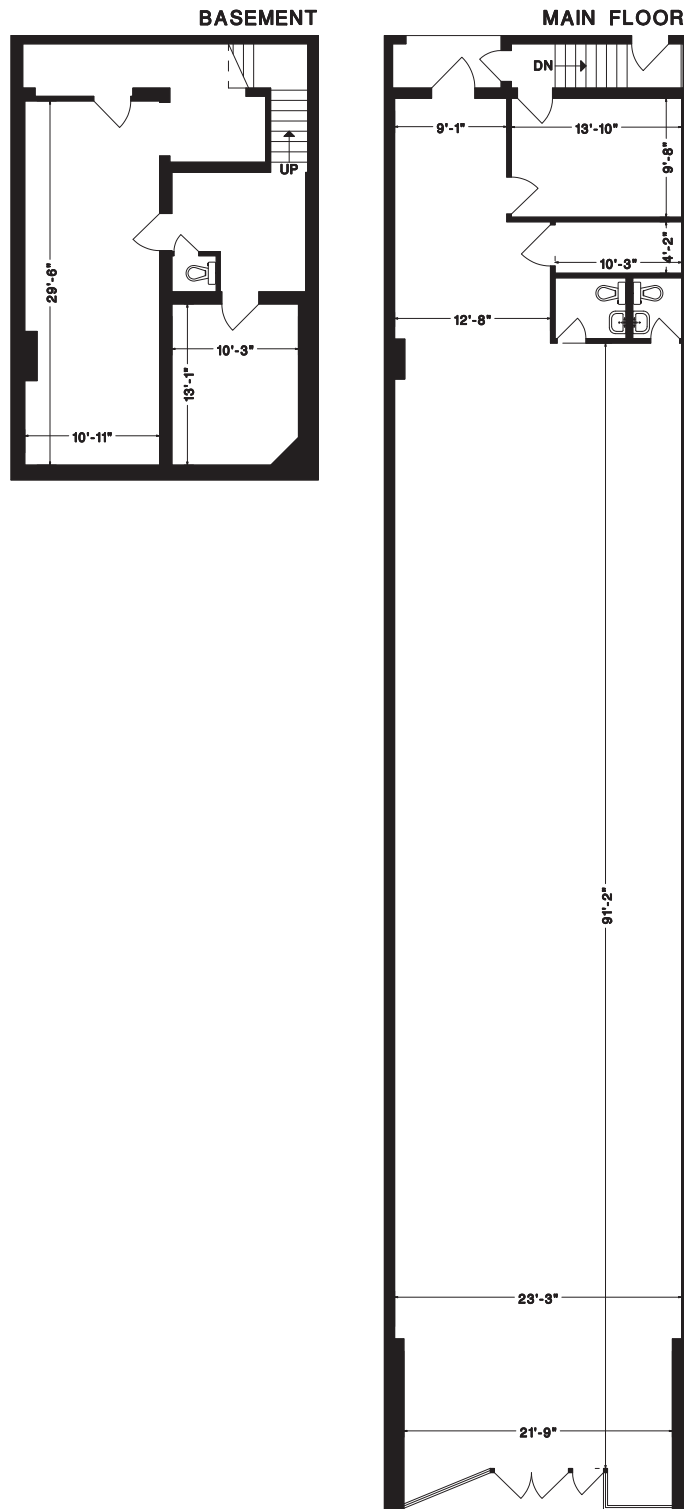

Flavio Unti
Sales Associate
Industrial Sales & Leasing
604 640 5889
flavio.unti@cushwake.com

Adam Frizzell
Vice President
604 640 5840
adam.frizzell@cushwake.com